



TEST & MEASUREMENT INSTRUMENTS



mVΩ



200



% 20.0



8888.88

55.01  
CO PPM 0  
209  
0  
8888.88  
RPM 20  
MVA  
MILIM  
18888.88  
072.1  
0721.4845  
34.8%  
75.0  
-0.393  
O2 % 20.0  
FLUE F 220  
2000 4845  
CO PPM 0  
209  
H OH 0  
8888.88  
18888.88  
55.01  
34.8%  
75.0  
18888.88  
072.1  
0721.4845  
% 20.0  
F 220  
209  
O2  
FLUE  
RPM 20  
MVA

PRODUCT CATALOG 2010



8888.88  
RPM 20  
MVA  
MILIM  
18888.88  
072.1  
0721.4845  
34.8%  
75.0  
-0.393  
O2 % 20.0  
FLUE F 220  
2000 4845  
CO PPM 0  
209  
H OH 0  
8888.88  
18888.88  
55.01  
34.8%  
75.0  
18888.88  
072.1  
0721.4845

## TABLE OF CONTENTS

CLAMP-ON METERS	3-5
DIGITAL MULTIMETERS	6-9
APOLLO THERMOMETERS	10
SCOUT IR THERMOMETERS	11
TEMPERATURE /HUMIDITY	10-13
THERMOMETERS	13
COMBUSTION	14-19
SMART BELL	17
EAGLE X & EAGLE	
COMBUSTION ANALYZERS	14-16
CO ANALYZERS/DETECTORS	17
INDUSTRIAL ANALYZERS	18-19
LEAK AND PRESSURE	
DETECTORS	21
SPECIALTY TESTERS	20
INSULATION RESISTANCE	
TESTERS	22
ELECTRICAL TESTERS	23
MOTORS	24
TRANSFORMERS	24
UTL	25
ACCESSORIES	26-28
PROBES & THERMISTORS	27
TEST LEADS	26
CLIPS & ADAPTERS	26
CASES	27
FUSES	25
MERCHANDISE / DISPLAYS	28



AIR CONDITIONING CONTRACTORS  
OF AMERICA



AMERICAN SOCIETY OF HEATING,  
REFRIGERATING & AIR-CONDITIONING ENGINEERS



HEATING, AIR CONDITIONING, & REFRIGERATION  
DISTRIBUTORS INTERNATIONAL



NATIONAL ASSOCIATION OF  
ELECTRICAL DISTRIBUTORS



NATIONAL APPLIANCE PARTS  
SUPPLIERS ASSOCIATION



AIR-CONDITIONING, HEATING AND  
REFRIGERATION INSTITUTE



## PRODUCT INDEX

383B/CATA2KIT	6	ATT36	27	DT302	10	RLDLS	21
550B	16	ATT39	27	DT304	10	RLDTF	21
7211	18	ATT50	27	DTH10	12	RP60	13
10051	18	ATT55A	27	DTH31	12	SDC	28
10533	18	ATT56A	27	DTH880	12	SM11103	16
12933	19	ATT57A	27	EAKIT	16	SMART BELL	17
13251	19	ATT58A	27	ECT120K	23	SP9	16
13910	19	ATT62	27	ECT1K	23	SPT1	16
13911	19	ATT64	27	ECT460K	23	T125/3	19
15154	19	ATT70	27	ECT690	23	T160	19
15588	18	ATTPC	26	ECTGFIK	23	T160/3	19
15590	18	AWL1	26	EM151	21	T220	19
16184	16	BF100	16	EM201	21	T220/3	19
16345	18	C75	16	FB1	18	TAZK	26
16486	19	C75KIT	15	FG80K	19	TC100	13
16646	16	C75/OILKIT	16	G120	19	TC70	13
17631	16	C125	16	G220	19	THL1	12
17662	16	C125KIT	15	HA1	22	UEM1021	24
17979	16	C125OILKIT	16	HVACKIT	4	UEM1021AL	24
18079	19	C127	16	HEADER	28	UEM1025	24
18131	19	C127KIT	15	INF155	11	UEM1041	24
AAC	26	C127OILKIT	16	INF185	11	UEM1041AL	24
AAC3	26	C155	14	INF215	11	UEM1042	24
AACA4	16	C155KIT	14	IRT20	22	UEM1042AL	24
AB13	26	C155OILKIT	14	IRT3	22	UEM1061	24
AB14	26	C157	14	KM9106/P	18	UEM1061AL	24
AC319	27	C157KIT	14	KM900PLUS	19	UEM1062	24
AC504	27	C157OILKIT	14	KM940	19	UEM1091	24
AC506	27	CA30	26	KMAF2	18	UEM1091AL	24
AC509	27	CA383B	26	KMCO1/Q	18	UEM1092	24
AC519	27	CALKIT	16	KMCP2	16	UEM1092AL	24
AC73	27	CD100A	21	KMCP10	19	UEM1161	24
AC75	27	CD200	21	KMCSP6	18	UEM1162	24
ACF1	26	CH3	3	KMCU110	18	UEM2042	24
ACS1	26	CLM100	20	KMCU220	18	UEM2091	24
AF2	25	CM11667/2	16	KMCU900/110	19	UEM2092	24
AF3	25	CO71A	17	KMFG1	19	UEM2161	24
AF5	25	CO91	17	KMHC104/Q	18	UEM2162	24
AF10	25	CO91KIT	17	KMIRP2	19	UET10	24
AF21	25	COS9	19	KMNO1/Q	18	UET100R	24
AF38	25	CPA1	26	KMNO2/Q	18	UET101	24
AF39	25	D460	16	KMPS2/Q	18	UET105	24
AF45	25	DAFM3	17	KMPS4	19	UET10A	24
AF112	25	DCM3	8	KMSO2/Q	18	UET111	24
AF113	25	DISPLAY 1	28	LPKIT	20	UET112	24
AF145	25	DISPLAY 2	28	LPKITPLUS	20	UET113	24
AF155	25	DL235	5	M110A	8	UET114	24
AF160	25	DL369	3	M1K	8	UET115	24
AF250	25	DL379	3	M20	8	UET150	24
AF251	25	DL379KIT	4	M75A	8	UET160	24
ALS1	26	DL389	3	MA1	23	UET175	24
ATHA1	26	DL389KIT	4	MCP4	5	UET20	24
ATL55	26	DL49	5	MCP9A	5	UET30	24
ATL59	26	DL99B	5	MM100	20	UET32	24
ATL60	26	DLM2	20	MW1AK	20	UET34	24
ATL85	26	DLMAT2	26	OS11	18	UET79R	24
ATL91	26	DM200	9	OS12	19	UTL2002	25
ATL130	26	DM383B	9	PBC	19	UTL260	25
ATL190	26	DM384	9	PDT550	16	UTL2K	25
ATL250	26	DM391	7	PET1	23	UTL33T	25
ATL301KIT	26	DM393	7	PSL/US	18	UTL55	25
ATLFSG	26	DM397	7	PSMR1	22	UTL7002	25
ATT100	27	DM5B	9	RE10LG	18	WN8	18
ATT19	27	DMEG3	22	RE20LG	18	WN9	18
ATT26	27	DOT2A	13	RE5LG	18	WT900	19
ATT27	27	DP12	18	RF60A	13	WT900/2	19
ATT29	27	DSM101	20	RFT2A	13	WT9106	18
ATT29A	27	DT15A	10	RH60	18	WTS9106	18
ATT30	27	DT20A	10	RLD10	21	WTS9106P	18
ATT31	27	DT301	10	RLD15	21		



### DL389 G2PHOENIX: PRO+

#### Functions

- True- RMS
- 4000µF Capacitance
- 2000µA AC/DC
- Non-Contact Voltage 24-600V AC
- 750V AC/1000V DC
- 400A AC
- 40MΩ Resistance
- Continuity
- Diode Check
- MIN/MAX
- -22° ~ 752°F Temperature (K type)

#### Features

- Dual Display
- Detachable Clamp Head
- Input Jack Lock
- Worklight
- Low Battery Display Lock
- EasyView High Contrast Backlight Display

- Magnetic Mount
- User Temperature Calibration
- Test Lead Storage
- Test Lead Holder on Clamp Head
- Auto Off
- Compatible with common Industry Accessory Heads
- Three Year Limited Warranty

#### Includes

- K-Type Temperature Probe ATT29
- Test leads ATL59
- Battery (2) AAA
- Manual
- Zippered carrying pouch



### DL379 G2PHOENIX: PRO

#### Functions

- 4000µF Capacitance
- 2000µA AC/DC
- Non-Contact Voltage 24-600V AC
- 750V AC/1000V DC
- 400A AC
- 40MΩ Resistance
- Continuity
- Diode Check
- MIN/MAX
- -22° ~ 752°F Temperature (K type)

#### Features

- Dual Display
- Detachable Clamp Head
- Input Jack Lock
- Worklight
- Low Battery Display Lock
- EasyView High Contrast Backlight Display

- Magnetic Mount
- User Temperature Calibration
- Test Lead Storage
- Test Lead Holder on Clamp Head
- Auto Off
- Compatible with common Industry Accessory Heads
- Three Year Limited Warranty

#### Includes

- K-Type Temperature Probe ATT29
- Test leads ATL59
- Battery (2) AAA
- Manual
- Zippered carrying pouch



### DL369 G2PHOENIX: PRIME

#### Functions

- 4000µF Capacitance
- 2000µA AC/DC
- Non-Contact Voltage 24-600V AC
- 750V AC/1000V DC
- 400A AC
- 40MΩ Resistance
- Continuity
- Diode Check
- MIN/MAX

#### Features

- Dual Display
- Low Battery Display Lock

- Test Lead Storage
- Test Lead Holder on Clamp Head
- Auto Off
- Three Year Limited Warranty

#### Includes

- Test leads ATL59
- Battery (2) AAA
- Manual
- Zippered carrying pouch



### CH3 G2PHOENIX: HOOK

#### Functions

- Measures 100A AC
- Non-Contact Voltage in tip
- Worklight
- Patented Virtual Closed Core Accuracy
- Three year limited warranty

#### Specifications

- Range: 0 – 100A
- Resolution: 0.1A
- Accuracy: 2.0% ±20 dgts
- Interference from adjacent wires: 0.03 – 1.0A

\* The "Hook" works exclusively with the G2 Phoenix PRO and PRO+

NOTE: CH3 does not measure true RMS when used with the G2 Phoenix PRO+ (DL389).



## CLAMP-ON MULTIMETERS

QUICK REFERENCE CHART	DL369	DL379	DL389	DL99B	DL235	DL49
AC Volts	750	750	750	1000	750	600
DC Volts	1000	1000	1000	1000	750	600
AC Amps	400	400	400	1000	700	400
DC Amps	-	-	-	1000	700	400
Frequency	.01~999.9kHz	.01~999.9kHz	.01~999.9kHz	-	.5~9,999Hz	-
AC/DC Micro Amps	0.1~2000µA	0.1~2000µA	0.1~2000µA	-	-	-
Capacitance	.01~4000µF	.01~4000µF	.01~4000µF	-	-	-
Temperature °F	-	-22~752°F	-22~752°F	-	-	--
Temperature °C	-	-30~400°C	-30~400°C	-	-	-
Resistance	0.1~40MΩ	0.1~40MΩ	0.1~40MΩ	40kΩ	4kΩ	40MΩ
Audible Continuity	<50Ω	<50Ω	<50Ω	<40Ω	<35Ω	<50Ω
True-RMS	-	-	X	X	X	-
Non Contact Voltage	24~600VAC	24~600VAC	24~600VAC	-	-	-
Dual Display	X	X	X	-	-	-
Detachable Clamp Head	-	X	X	-	-	-
Accepts Industry Accessory Heads	-	X	X	-	-	-
User Temperature Calibration	-	X	X	-	-	-
Worklight	-	X	X	X	-	-
Backlit Display	-	EasyView	EasyView	-	-	-
MIN/MAX	X	X	X	-	X	-
Autorangeing	Auto/Man	Auto/Man	Auto/Man	Auto/Man	Auto/Man	Auto
Peak Hold	-	-	-	X	X	X
Data Hold	X	X	X	X	X	X
Auto Off	X	X	X	X	X	X
Low Battery Indicator	Display Lock	Display Lock	Display Lock	X	X	X
Warranty	3yr	3yr	3yr	3yr	5yr	3yr
Safety Ratings	UL CAT III 600V CAT II 1000V	UL CAT III 600V CAT II 1000V	UL CAT III 600V CAT II 1000V	UL CAT III 600V	CAT II	UL CAT III 600V
Test Leads	ATL59	ATL59	ATL59	ATL55	ATL55	ATL55
Alligator Clips	AAC3	AAC3	AAC3	AAC	AAC	AAC
Battery	"AAA" (2)	"AAA" (2)	"AAA" (2)	9V	9V	9V
Temperature Probe	-	K-Type	K-Type	-	-	-
Thermocouple (K-type)	-	ATT29	ATT29	-	-	-
Case	X	X	X	X	X	X
Flame Safeguard Test Kit	ATLFSG	ATLFSG	ATLFSG	-	-	-
Microwave Diode Booster	ATL60	ATL60	ATL60	-	-	-
Line Splitter	ALS1	ALS1	ALS1	ALS1	ALS1	ALS1
Dual Input Temperature Adapter	TA2K	TA2K	TA2K	TA2K	TA2K	TA2K
Micro Amp Adapter	DLMAT2	DLMAT2	DLMAT2	DLMAT2	DLMAT2	DLMAT2
Capacitance Adapter	CPA1	CPA1	CPA1	CPA1	CPA1	CPA1
Optional Storage Case	AC519	AC519	AC519	AC519	AC519	AC519

### HVACKIT\*

#### HVAC SPECIALTY KIT

Also Available:

HVACKITPRO

With the DL389

True RMS Clamp Meter

\* Available and certified in Canada as the HVACKIT1 and the HVACKITPRO1

#### Includes

- G2Phoenix Pro (DL379)
- G2Phoenix Hook (CH3)
- Scout 1 (INF155)
- PET1 or NCV2 Non Contact Voltage Meter (NCV2 Canada Only)

- ATTPC Pipe Clamp Adapter
- Soft Carrying Case (AC73)



### DL379KIT

#### G2PHOENIX: PRO KIT

#### Includes

- |                          |         |
|--------------------------|---------|
| G2Phoenix Pro            | DL379   |
| G2Phoenix Hook           | CH3     |
| K-Type Temperature Probe | ATT29   |
| Test leads               | ATL59   |
| Battery                  | (2) AAA |

Manual  
Zippered carrying pouch



### DL389KIT

#### G2PHOENIX: PRO+ KIT

#### Includes

- |                          |         |
|--------------------------|---------|
| G2Phoenix Pro+           | DL389   |
| G2Phoenix Hook           | CH3     |
| K-Type Temperature Probe | ATT29   |
| Test leads               | ATL59   |
| Battery                  | (2) AAA |

Manual  
Zippered carrying pouch



**DL99B**  
TRUE-RMS  
DIGITAL CLAMP METER

**Functions**

- True RMS
- 1000 Amps AC and DC
- 1000 Volts AC and DC
- Resistance to 40kΩ
- Continuity <40 ohms
- 0.1 mV DC resolution allows use of DMM adapters

**Features**

- Work light and backlit display
- Push-button ranging

- Peak hold
- Data hold
- 1-3/8" jaw capacity
- Three year limited warranty

**Includes**

- Test leads ATL55
- Battery (1) 9V
- Holdster
- Manual



**DL49**  
ELECTRICAL  
DIGITAL CLAMP METER

**Functions**

- 400 Amps AC and DC
- 600 Volt AC and DC
- Resistance to 40 MΩ
- Continuity <50 ohms
- 1 mV DC resolution allows use of DMM adapters

**Features**

- Autoranging
- AC Amps peak hold
- Data hold
- 1-1/4" Jaw capacity
- Three year limited warranty

**Includes**

- Test leads ATL55
- Battery (1) 9V
- Holdster
- Manual



**DL235**  
TRUE-RMS  
SPECIALTY CLAMP METER

**Functions**

- True RMS
- 700 Amps AC and DC
- 750 Volts AC and DC
- Resistance to 4kΩ
- Continuity <35 ohms
- Frequency to 10 kilohertz

**Features**

- Auto or manual ranging
- Soft mode smooths amp, frequency or voltage readings
- Crest mode displays 1/2 wave peak to calculate crest factor
- MIN/MAX record
- 2-1/6" jaw capacity

- 3-3/4 digit 4000 count LCD display
- Data hold
- Low battery indication
- Auto power off
- Five year limited warranty

**Includes**

- Test leads ATL55
- Screw-on alligator clips AAC3
- Battery (1) 9V
- Holster
- Manual



**MCP4**  
ANALOG CLAMP METER

**Functions**

- 10 Ranges
- 300 Amps AC
- 750 Volts AC
- Resistance to 1000 ohms
- Color-coded, high resolution scale-plate
- Pointer-lock switch (data hold)
- 1-1/4" jaw capacity
- Three year limited warranty

**Includes**

- Test leads ATL55
- Battery (1) AAA
- Fuse AF3
- Carrying Case
- Manual



**MCP9A**  
ANALOG CLAMP METER

**Functions**

- 9 Ranges
- 300 Amps AC
- 600 Volts AC
- Resistance to 1000 ohms
- Color-coded, high resolution scale-plate
- Pointer-lock switch (data hold)
- 1-1/2" jaw capacity
- Three year limited warranty

**Includes**

- Test leads ATL130
- Fuse AF45
- Battery Std "AA" 1.5V
- Carrying Case
- Manual





## DIGITAL MULTIMETERS

### QUICK REFERENCE CHART

	DM397	DM393	DM391	DM384	DM383B	DM200	DM5B
<i>True-RMS</i>	X	X	-	-	-	-	-
<i>AC Volts</i>	1000	1000	1000	1000	1000	600	750
<i>DC Volts</i>	1000	1000	1000	750	750	600	750
<i>AC+DC Volts</i>	1000	-	-	-	-	-	-
<i>AC Amps</i>	10	10	10	10	10	-	5
<i>DC Amps</i>	10	10	10	10	10	-	5
<i>AC+DC Amps</i>	10	-	-	-	-	-	-
<i>dB &amp; dBV</i>	199Ω/5.9999V	-	-	-	-	-	-
<i>Pulse Width</i>	0.5Hz ~ 300kHz	-	-	-	-	-	-
<i>Temperature °F</i>	-58° ~ 2,498°	-40° ~ 2,372°	-	-	-	-	-
<i>Temperature °C</i>	-50° ~ 1,370°	-40° ~ 1,300°	-	-	-	-	-
<i>Capacitance</i>	5nF ~ 5000 μF	40nF ~ 100 μF	40nF ~ 100 μF	4nF ~ 40,000 μF	-	-	-
<i>Frequency</i>	500.00Hz ~ 5.0000MHz	5Hz ~ 40MHz	5Hz ~ 10MHz	4kHz ~ 10MHz	-	-	-
<i>Resistance</i>	50Ω ~ 50MΩ	400Ω ~ 10MΩ	400Ω ~ 10MΩ	400Ω ~ 40MΩ	400Ω ~ 40MΩ	200Ω	30MΩ
<i>Diode Test</i>	X	X	X	X	X	X	X
<i>Continuity</i>	X	X	X	X	X	X	X
<i>RS232 Data Port</i>	X	-	-	-	-	-	-
<i>Analog Bar Graph</i>	X	-	-	X	-	-	-
<i>Data Storage &amp; Recall</i>	X	-	-	-	-	-	-
<i>1m Second Peak Capture</i>	X	-	-	-	-	-	-
<i>Average</i>	X	-	-	-	-	-	-
<i>Display Count</i>	5,000	4,000	4,000	4,000	4,000	2,000	4,000
<i>Backlit Display</i>	X	X	X	EasyView	EasyView	-	-
<i>Relative Mode</i>	X	X	X	-	-	-	-
<i>MIN/MAX</i>	X	X	-	X	MAX	-	-
<i>Data Hold</i>	X	X	X	X	X	-	X
<i>Auto Power Off</i>	X	X	X	-	-	X	X
<i>Low Battery Indicator</i>	X	X	X	X	X	X	X
<i>Closed Case Calibration</i>	X	X	X	-	-	-	-
<i>Limited Warranty</i>	5yr	5yr	5yr	5yr	5yr	1yr	3yr
<i>Safety Ratings</i>	UL CAT III 1000V	UL CAT III 1000V	UL CAT III 1000V	UL CAT III 600V	UL CAT III 600V	UL CAT II 600V	-
<i>Test Leads</i>	ATL55	ATL55	ATL55	ATL55	ATL55	ATL55	ATL250
<i>Alligator Clips</i>	AAC	AAC	AAC	AAC	AAC	AAC	AAC
<i>Battery</i>	9V	9V	9V	9V	9V	9V	AB13 (2)
<i>Fuse</i>	AF38, AF39	AF38, AF39	AF38, AF39	AF155, AF160	AF155, AF160	-	AF250/AF251
<i>Temperature Probe</i>	ATT29	ATT29	-	-	-	-	-
<i>Temperature Plug Adapter</i>	ATT70	ATT70	-	-	-	-	-
<i>Software</i>	X	-	-	-	-	-	-
<i>Computer Cables</i>	X	-	-	-	-	-	-
<i>Optional Accessories*</i>							
<i>Flame Safeguard Test Kit</i>	ATLFSG	ATLFSG	ATLFSG	ATLFSG	ATLFSG	-	-
<i>Premium Silicon Leads</i>	ATL300	ATL300	ATL300	ATL300	ATL300	-	-
<i>AC/DC Current Clamp Adapter</i>	CA383B, CA30	CA383B, CA30	CA383B, CA30	CA383B, CA30	CA383B, CA30	-	-
<i>Dual Temperature Adapter</i>	TA2K	TA2K	TA2K	TA2K	TA2K	-	-
<i>Line Splitter</i>	ALS1	ALS1	ALS1	ALS1	ALS1	-	-
<i>Micro Amp Adapter</i>	DLMAT2	DLMAT2	DLMAT2	DLMAT2	DLMAT2	-	-
<i>Temperature Probe</i>	K-Type	K-Type	-	-	-	-	-
<i>Thermocouple mV Adapter</i>	ATHA1	ATHA1	ATHA1	ATHA1	ATHA1	-	-
<i>Optional Storage Case</i>	AC519	AC319	AC319	AC319	AC319	AC319	-

\* More Info in Accessories pg.25-27

### 383B/CATA2KIT

All In One Kit

#### Kit includes

- DM383B Digital Multimeter
- CA383B Clamp-On Adapter
- TA2K Dual Input Adapter
- Two 4" K-type Temperature Probes
- AC504 Hard Carrying Case



**DM397**  
TRUE-RMS  
DIGITAL MULTIMETER

**Functions**

- True RMS
- 1000 AC/DC & AC+ DC Volts
- 10 AC/DC & AC+ DC Amps
- dBm & dBV
- Resistance 50MΩ
- Conductance 50nS
- Frequency 50Hz-5MHz
- Duty Cycle 0.1%-99.9%
- Pulse Width 0.5Hz-300kHz
- Temperature -58°-2.372°F
- Capacitance 5nF-5000μF
- Diode Test 4V
- Continuity <10Ω  
(response time <1m sec)

**Features**

- Relative Mode and (RELA) mode
- Analog bar graph
- Data Logging kit with software
- Data storage & recall
- MIN/MAX/AVG
- 1mS Peak Capture
- Data Hold
- Auto power off
- Audible & visual input warnings

- 50,000 count primary display
- 5,000 count secondary display
- Backlit display
- All input, ranges, & functions protected to 1000 V CAT III
- Closed case calibration
- Access to battery and fuses without breaking calibration seals
- Open fuse detection
- Five year limited warranty

**Includes**

Test leads	ATL55
Screw-on alligator clips	AAC3
K type temperature probe	ATT29
K type temperature adapter	ATT70
Battery	(1) 9V
Fuses	AF38, AF39
Software	
Manual	



**DM393**  
TRUE-RMS  
DIGITAL MULTIMETER

**Functions**

- True RMS AC Volts and Amps
- 1000V AC/DC
- 10A AC/DC
- 0.5% basic DC accuracy
- Frequency 10Mhz
- Capacitance 100μF
- Temperature: -40° to 2372°F
- Resistance 40MΩ
- Diode test 4V
- Continuity >10Ω

**Features**

- All inputs, ranges and functions protected to 1000 V CAT III
- Access to battery and fuses without breaking calibration
- 4,000 count backlit display

- Relative mode
- Hold
- Autoranging
- Five year limited warranty

**Includes**

Test leads	ATL55
Screw-on alligator clips	AAC3
K type temperature probe	ATT29
K type temperature adapter	ATT70
Battery	(1) 9V
Fuses	AF38, AF39
Manual	



**DM391**  
DIGITAL MULTIMETER

**Functions**

- 1000V AC/DC
- 10A AC/DC
- 0.5% basic DC accuracy
- Frequency 10Mhz
- Capacitance 100μF
- Resistance 40MΩ
- Diode test 4V
- Continuity >10Ω

**Features**

- All inputs, ranges and functions protected to 1000 V CAT III
- Access to battery and fuses without breaking calibration
- 4,000 count backlit display
- Relative mode
- Hold
- Autoranging
- Five year limited warranty

- 1000V AC/DC
- 10A AC/DC
- 0.5% basic DC accuracy
- Frequency 10Mhz
- Capacitance 100μF
- Resistance 40MΩ
- Diode test 4V
- Continuity >10Ω



**M110A**  
ANALOG MULTIMETER

**Functions**

- 21 Ranges
- 600 Volts AC
- 300 Volts DC
- 2M $\Omega$  Resistance
- High resolution DC  $\mu$ A for flame safeguard testing
- DC millivolt scale allows use of adapters
- Color-coded and mirrored scale plate
- Three year limited warranty

**Includes**

- Test leads \_\_\_\_\_ ATL55
- Fuse .15A \_\_\_\_\_ AF10
- Battery \_\_\_\_\_ (1) 9V
- Carrying Case \_\_\_\_\_
- Manual \_\_\_\_\_



**M75A**  
ANALOG MULTIMETER

**Functions**

- 17 Ranges
- 1000 Volts AC/DC
- 50k $\Omega$  Resistance
- DC micro/miliamps
- DC millivolt scale allows use of adapters
- Color-coded and mirrored scale plate
- Three year limited warranty

**Includes**

- Test leads \_\_\_\_\_ ATL55
- Fuse .15A \_\_\_\_\_ AF5
- Battery \_\_\_\_\_ (2) AA
- Carrying Case \_\_\_\_\_
- Manual \_\_\_\_\_



**M20**  
ANALOG MULTIMETER

**Functions**

- 12 Ranges
- 500 Volts AC & DC
- DC milliamps
- Fused ohm circuit
- Resistance to 500 kilohms
- Color-coded and mirrored scale plate
- Three year limited warranty

**Includes**

- Test leads \_\_\_\_\_ ATL85
- Fuse .25A \_\_\_\_\_ AF2
- Battery \_\_\_\_\_ (1) Std "AA" 1.5V
- Manual \_\_\_\_\_



**M1K**  
ANALOG MULTIMETER

**Functions**

- 15 Ranges
- 500 Volts AC & DC
- 500K $\Omega$  Resistance
- DC milliamps
- Decibel measurements
- Color-coded and mirrored scale plate
- Three year limited warranty

**Includes**

- Test leads \_\_\_\_\_ ATL85
- Battery \_\_\_\_\_ (1) Std "AA" 1.5V
- Manual \_\_\_\_\_



**DCM3**  
DIGITAL CAPACITANCE METER

**Functions**

- 9 ranges, 200pF~20mF (20,000  $\mu$ F)
- Zero adjustment
- OVER RANGE indicator
- Polarity indicator
- Quick display refresh rate
- Fuse protected input
- One year limited warranty

**Includes**

- Battery \_\_\_\_\_ (1) Std 9V
- Test Leads \_\_\_\_\_
- Manual \_\_\_\_\_





**DM384**  
DIGITAL MULTIMETER

**Functions**

- 750 Volts AC & 1000 Volts DC
- 10 Amps AC & DC
- Resistance to 40 MΩ
- .01 μA DC resolution for flame safe guard circuit testing
- Frequency to 40 MHz
- Capacitance to 40,000 Microfarad
- Diode Test
- Continuity

**Features**

- 3-3/4" Digit, 4000 count display
- Analog bar graph
- MIN/MAX
- Data hold
- EasyView display

- Low Battery Indicator
- On-screen range and function indicators
- CE and UL listed 600V CAT III
- Five year limited warranty

**Includes**

Test leads	ATL55
Screw-on alligator clips	AAC3
Battery	(1) 9V
Fuses	AF155, AF160
Manual	



**DM383B**  
DIGITAL MULTIMETER

**Functions**

- 750 Volts AC & 1000 Volts DC
- 10 Amps AC & DC
- Resistance to 40 MΩ
- 0.1μA DC resolution for flame safe guard circuit testing
- Diode Test
- Continuity

**Features**

- New – EasyView Display
- 3 3/4" Digit, 4000 count display
- Max capture mode
- Data hold
- On-screen range and function indicators
- CE and UL listed 600V CAT III
- Five year limited warranty

**Includes**

Test leads	ATL55
Screw-on alligator clips	AAC3
Battery	(1) 9V
Fuses	AF155, AF160
Manual	



**DM200**  
DIGITAL MULTIMETER

**Functions**

- Volts 600 AC & DC
- Continuity
- Resistance to 200 ohms

**Features**

- Manual ranging
- 3-1/2" digit, 2000 count display
- Protective rubber boot
- One year limited warranty

**Includes**

Test leads	ATL55
Screw-on alligator clips	AAC3
Battery	(1) 9V
Manual	



**DM5B**  
POCKET-SIZE  
DIGITAL MULTIMETER

**Functions**

- 750 Volts AC & DC
- 5 Amps AC & DC
- Continuity
- Resistance to 40MΩ
- Pocket-sized
- Auto ranging
- Data hold
- Fuse protected current ranges
- Three year limited warranty

**Includes**

Test leads	ATL250
Battery	(2) AB13
Fuses	AF250, AF251
Protective Case	
Manual	



**DT304**  
**APOLLO IV**  
 QUAD INPUT  
 DIGITAL LOGGING  
 THERMOMETER

**Functions**

- Quad Thermocouple input
- Differential T1-T2 and T3-T4
- Temp range -346° to +2192°F (J)
- Temp range -328° to +2498°F (K)
- Data logging
- 9,999 Memory positions
- USB interface (software included)
- Thermocouple temperature offset
- MIN, MAX, AVG & Hold
- Probe Storage
- Accepts J, K, T and E type probes
- 5 year limited warranty

**Includes**

- 4 K type probes w/ lead wraps ATT39
- Batteries 2 "AAA"
- Software
- Owners Manual



**DT302**  
**APOLLO II**  
 DUAL INPUT  
 DIGITAL LOGGING  
 THERMOMETER

**Functions**

- Dual Thermocouple input
- Differential T1-T2
- Temp range -346° to +2192°F (J)
- Temp range -328° to +2498°F (K)
- Data logging
- 9,999 Memory positions
- USB interface (software included)
- Thermocouple temperature offset
- MIN, MAX, AVG & Hold
- Probe Storage
- Accepts J, K, T and E type probes
- 5 year limited warranty

**Includes**

- 2 K type probes w/lead wraps ATT39
- Batteries 2 "AAA"
- Software
- Owners Manual



**DT301**  
**APOLLO I**  
 SINGLE INPUT  
 DIGITAL LOGGING  
 THERMOMETER

**Functions**

- Single Thermocouple input
- Relative Mode
- Temp range -346° to +2192°F (J)
- Temp range -328° to +2498°F (K)
- Data logging
- 9,999 Memory positions
- USB interface (software included)
- Thermocouple temperature offset
- MIN, MAX, AVG & Hold
- Probe Storage
- Accepts J, K, T and E type probes
- 5 year limited warranty

**Includes**

- 1 J type probe with clip ATT19
- Batteries 2 "AAA"
- Software
- Owners Manual



**DT20A**  
 DUAL INPUT DIGITAL  
 THERMOMETER

**Functions**

- -58 to 571°F (-50 to 300°C)
- Dual probe inputs
- Dual display lets you monitor any two of T1, T2 or differential (ΔT)
- MIN/MAX record
- High visibility backlit display
- Data hold
- Includes two replaceable, submersible metal probes
- Three year limited warranty

**Includes**

- Thermistor Probes (2) ATT55A
- Battery (3)AAA
- Manual



**DT15A**  
 DIGITAL  
 THERMOMETER

**Functions**

- -58 to 571°F (-50 to 300°C)
- MIN/MAX record
- Electroluminescent backlit display
- Data hold
- Includes one replaceable, submersible metal probe
- Three year limited warranty

**Includes**

- Thermistor Probes (2) ATT55A
- Battery (3)AAA
- Manual





**INF215**  
**SCOUT III**  
INFRARED THERMOMETER

**Functions**

- 30:1 Distance to Spot Ratio
- Temperature Range -76° to 1400°F
- Laser targeting
- UV Worklight
- Min/Max/Avg/Differential
- Adjustable emissivity levels
- 60 Second Auto Hold
- Hi/low Alarm (User adjustable)
- K-Type contact probe input
- Backlit display
- Over-molded handle with comfort grip
- Low Battery indicator
- Three year limited warranty

**Includes**

- 1 K type probes ATT29A
- Batteries 2 "AAA"
- Holster
- Owners Manual



**INF185**  
**SCOUT II**  
INFRARED THERMOMETER

**Functions**

- 12:1 Distance to Spot Ratio
- Temperature Range -76° to 932°F
- Laser targeting
- Worklight
- Min/Max/Differential
- Adjustable emissivity levels
- Auto off
- Hi/low Alarm (User adjustable)
- K type contact probe input
- Backlit display
- Over-molded handle with comfort grip
- Built-in carrying strap
- Low Battery indicator
- Three year limited warranty

**Includes**

- 1 K type probes ATT29A
- Batteries 2 "AAA"
- Holster
- Owners Manual



**INF155**  
**SCOUT I**  
INFRARED THERMOMETER

**Functions**

- 12:1 Distance to Spot Ratio
- Wide Temperature Range -58 ~ 750°F
- Laser targeting
- Max Value Capture
- Fixed Emissivity (0.95)
- Auto Off
- Backlit Display
- Over-Molded Handle with Comfort Grip
- Low Battery Indicator
- Three Year Limited Warranty

**Includes**

- Batteries 2 "AAA"
- Holster
- Owners Manual



**PDT550**  
DIGITAL POCKET  
THERMOMETER

**Functions**

- Waterproof
- -58 to 572°F (-50 to 300°C)
- Built-in magnetic mount
- MIN/MAX record
- Dual purpose probe cover serves as thermometer extension
- Auto power off
- Quick and easy to read
- Three year limited warranty

**Includes**

- Batteries AB13
- Colors available: Red, Green, Blue, Yellow, Black.
- Sold in Lots of five (Assorted Colors)



**550B**  
DIGITAL POCKET  
THERMOMETER

**Functions**

- -58° to 572°F
- Water resistant
- MIN/MAX
- Protective boot
- Magnetic mount
- Data hold
- Auto power off
- New ergonomic designed head
- Pen style sheath
- Three year limited warranty

**Includes**

- Batteries AB13
- Sold in Lots of five



### DAFM3 DIGITAL AIRFLOW METER

#### Features

- Measures
  - Temperature -4~140°F (-20~60°C)
  - Air Velocity 1~114 ft/s
  - Relative Humidity
- Calculates
  - Dew Point -50~158°F (-68~70°C)
  - Wet Bulb -7.6~158°F (-22~70°C)
  - Volume 0~99,999 CFM
- Protective twist cap for temperature/humidity sensor
- 8-Point Average for Air Velocity
- 60 Second Average for Air Volume
- Total Volume from multiple outlets
- Large LCD digital display
- Professional remote vane

- English/Metric scales
- Low battery indication
- Fast response
- Microprocessor circuitry for reliability
- Auto Power Off selectable
- Powered by 4 "AAA" batteries
- One year limited warranty

#### Includes

- Battery \_\_\_\_\_ (1) Std 9V
- Carrying Case
- Manual



### THL1 TEMPERATURE AND HUMIDITY LOGGER

*NOTE: Requires computer w/Windows™ 32bit and a USB interface to operate.*

#### Functions

- 32,000 data points
  - 16,000 Temperature
  - 16,000 Relative Humidity)
- Analysis software with dew point calculation, charting of results, and export to other file formats
- USB interface
- Windows™ compatible software
- Instant or manual start
- Alarm LED's with user selectable values

- Magnetic mount
- Long battery life
- One year limited warranty

#### Includes

- Battery \_\_\_\_\_ 3.5V Lithium
- Software
- Manual



### DTH31 DIGITAL PSYCHROMETER

#### Functions

- Triple Display shows RH% T1 (ambient) and WB
- Ambient temperature (T1) -4~122°F (-20~50°C)
- RH humidity
- Dew point -90~122°F (-68~50°C)
- Wet bulb -69~122°F (-21~50°C)
- Display resolution 0.1 °C/°F
- Protective sensor cap
- Sensor: Electronic capacitance polymer film
- Condensation will not affect accuracy
- Hold
- MIN/MAX
- °C or °F switchable
- Low battery indicator

- Pocket size design
- Reset
- Auto off with by-pass
- One year limited warranty

#### With optional External Probe (ATT31)

- External temperature (T2)
- T1 – T2
- T2 – Dew point (check difference of surface to dew point)

#### Includes

- Batteries \_\_\_\_\_ (2) AAA
- Manual



### DTH10 DIGITAL THERMOS- HYGROMETER

#### Functions

- Temperature in °F or °C (14~122°F / -10 to 50°C)
- 5 to 95% Relative Humidity (RH)
- Fast, accurate electronic sensor
- Displays relative humidity and temperature at the same time
- MIN/MAX record
- Data hold
- Auto power-off
- One year limited warranty

#### Includes

- Battery \_\_\_\_\_ (2) AAA
- Manual



### DTH880 TEMPERATURE AND HUMIDITY TESTER

#### Functions

- Temperature in °F or °C (32 to 122°F/0 to 50°C)
- 25 to 95% relative humidity (RH)
- Comfort zone indicator
- Displays relative humidity and temperature at the same time
- MIN/MAX record
- Data hold
- One year limited warranty

#### Includes

- Battery \_\_\_\_\_ (1) "AAA"
- Manual



**RF60A**  
VAPOR TENSION  
THERMOMETER

- Functions**
- Remote reading
  - Recessed flange-mount
  - -40 - 60° (-40 - 15°C)
  - 2°F/C per division
  - 2" Dial with 3" mounting flange
  - 48" Nickel plated, rear-mounted capillary
  - Color-coded scales

- Easy pointer calibration
- NSF listed
- One year limited warranty



**RP60**  
VAPOR TENSION  
THERMOMETER

- Functions**
- Remote reading
  - Recessed flange-mount
  - -40 to 60° (-40 to 15°C)
  - 2°F/C per division
  - 4" Dial with 5" mounting flange
  - 48" Nickel plated, bottom mounted capillary

- High impact plastic housing
- Color-coded scales
- One year limited warranty



**RH60**  
VAPOR TENSION  
THERMOMETER

- Functions**
- Remote reading
  - Hanger mount
  - -40 to 60°F (-40 to 15°C)
  - 2°F/C per division
  - 2" Dial with hanger strap
  - 48" Nickel plated capillary with bottom connection

- Color-coded scales
- Easy pointer calibration
- NSF listed
- One year limited warranty



**RFT2A**  
REFRIGERATION / FREEZER  
THERMOMETER

- Functions**
- -20 to 80°F (-30 to 30°C)
  - 2°F/1°C per division
  - Hangs or stands
  - Stainless steel frame
  - One year limited warranty



**DOT2A**  
OVEN THERMOMETER

- Functions**
- 200 to 550°F (65 to 290°C)
  - 25°F/10°C per division
  - Hangs or stands
  - Stainless steel frame
  - One year limited warranty



**FG80K**  
REFRIGERATOR / FREEZER  
THERMOMETER

- Functions**
- -40 to 80°F (-40 to 27°C)
  - Large 5" x 1 1/4" scale plate
  - Red spirit-filled (contains no mercury)
  - Hangs or stands
  - NSF listed
  - One year limited warranty



**G120 & G220**  
VAPOR RETENTION  
THERMOMETER

**Functions**  
5" spirit-filled glass pocket thermometers for HVAC/R and food service applications. Includes an eyelet for attaching a strap or cord and a metal case with pocket clip.

- Mercury Free!
- Glass spirit with protective sleeve
- Range:
  - G120: -40° to 120°F
  - G220: 0° to 220°F



**POCKET DIAL  
THERMOMETERES**

#Stock	Scale	Deg/Div.	Range	Length	UPC
<b>T160</b>	1"	2°	-40° a +160°F	5"	05353370007
<b>T220</b>	1"	2°	0° a +220°F	5"	05353370011
<b>TC70</b>	1"	1°	-40° a +70°C	5"	05353370021
<b>TC100</b>	1"	1°	-10° a +100°C	5"	05353370019
<b>T125/3</b>	1-3/4"	1°	+25° a +125°F	5"	05353370005
<b>T160/3</b>	1-3/4"	2°	-40° a +160°F	5"	05353370008
<b>T220/3</b>	1-3/4"	2°	0° a +220°F	5"	05353370012

- One year limited warranty



## C157KIT

### EAGLE 3X

XTENDED LIFE  
COMBUSTION & SYSTEM  
ANALYZER KIT



#### Kit Includes

##### C157 Combustion Analyzer

Infrared Thermal Printer	KMIRP2
Flue Probe	KMCP2
(2) K-Type Temperature Probe	ATT29
(2) Static Pressure Hoses	SPP
True Draft Probe	TDP
Gas Pressure Probe	GPP
AC Adapter	AACA4
Hard Carrying Case	AC509
Thermal printer paper roll	16646
Particle filter	17631

#### C157 Analyzer Features

- Measures:  
CO<sub>2</sub>, CO, NO<sub>1</sub>, Inlet Temperature, Flue Temperature, Hi-Res Pressure (.01-.001wg)
- Calculates:  
O<sub>2</sub>, Net Temperature, Efficiency, Excess Air, Differential Temp. (T1-T2), Differential Pressure (P1-P2), CO Air free

- Room CO Data Logger
- Heat Exchange Integrity Test
- Worklight
- 4 line backlit LCD display
- 179 memory positions
- Customizable display parameters
- Programmable Headers
- Individual report printouts
- Unique rotary selector dial
- Protective boot w/integral magnet
- Real time clock
- CO readings to 1 ppm
- Infrared printer port
- Field Replaceable Sensors<sup>1,2</sup>
- 5 year limited warranty  
Includes sensors



## C157

### EAGLE 3X

COMBUSTION ANALYZER

#### Includes

Flue Probe	KMCP2
Inlet Tube/ Probe Connector	SM11103
Particle filter	17631
Hard carrying case	AC509



## C157OILKIT

OIL SERVICE KIT

#### Kit Includes

Same contents as the C157KIT  
Includes a Smoke Pump Tester (SPT1)



## C155KIT

### EAGLE 2X

XTENDED LIFE  
COMBUSTION & SYSTEM  
ANALYZER KIT



#### Kit Includes

##### C155 Combustion Analyzer

Infrared Thermal Printer	KMIRP2
Flue Probe	KMCP2
(2) K-Type Temperature Probe	ATT29
(2) Static Pressure Hoses	SPP
True Draft Probe	TDP
Gas Pressure Probe	GPP
AC Adapter	AACA4
Hard Carrying Case	AC509
Thermal printer paper roll	16646
Particle filter	17631

#### C155 Analyzer Features

- Measures:  
CO<sub>2</sub>, CO, Inlet Temperature, Flue Temperature, Hi-Res Pressure (.01-.001wg)
- Calculates:  
O<sub>2</sub>, Net Temperature, Efficiency, Excess Air, Differential Temp. (T1-T2), Differential Pressure (P1-P2), CO Air free

- Room CO Data Logger
- Heat Exchange Integrity Test
- Worklight
- 179 memory positions
- Customizable display parameters
- Programmable Headers
- Individual report printouts
- Unique rotary selector dial
- Protective boot w/integral magnet
- Real time clock
- CO readings to 1 ppm
- Large 4 line back-lit display
- Infrared printer port
- Field Replaceable Sensors<sup>1</sup>
- 5 year limited warranty  
Includes sensors



## C155

### EAGLE 2X

COMBUSTION ANALYZER

#### Includes

Flue Probe	KMCP2
Inlet Tube/ Probe Connector	SM11103
Particle filter	17631
Hard carrying case	AC509



## C155OILKIT

OIL SERVICE KIT

#### Kit Includes

Same contents as the C155KIT  
Includes a Smoke Pump Tester (SPT1)



**C127KIT**  
**EAGLE 3**  
 COMBUSTION & SYSTEM  
 ANALYZER KIT



**Kit Includes**

C127 Combustion Analyzer	KMIRP2
Infrared Thermal Printer	KMCP2
Flue Probe	ATT29
(2) K-Type Temperature Probe	SPP
(2) Static Pressure Hoses	TDP
True Draft Probe	GPP
Gas Pressure Probe	AACA4
AC Adapter	AC509
Hard Carrying Case	16646
Thermal printer paper roll	17631
Particle filter	

**C127 Analyzer Features**

- **Measures:**  
 NO1, O2, CO, Inlet Temperature, Flue Temperature, Hi-Res Pressure (.01~.001wg)
- **Calculates:**  
 CO2, Net Temperature, Efficiency, Excess Air, Differential Temp. (T1-T2), Differential Pressure (P1-P2), CO Air free

- Room CO Data Logger
- Heat Exchange Integrity Test
- Worklight
- 4 line backlit LCD display
- 179 memory positions
- Customizable display parameters
- Programmable Headers
- Individual report printouts
- Unique rotary selector dial
- Protective boot w/integral magnet
- Real time clock
- CO readings to 1 ppm
- Infrared printer port
- Field Replaceable Sensors<sup>1,2</sup>
- 3 year limited warranty (2 year warranty on sensor)



**C125KIT**  
**EAGLE 2**  
 COMBUSTION & SYSTEM  
 ANALYZER KIT



**Kit Includes**

C125 Combustion Analyzer	KMIRP2
Infrared Thermal Printer	KMCP2
Flue Probe	ATT29
(2) K-Type Temperature Probe	SPP
(2) Static Pressure Hoses	TDP
True Draft Probe	GPP
Gas Pressure Probe	AACA4
AC Adapter	AC509
Hard Carrying Case	16646
Thermal printer paper roll	17631
Particle filter	

**C125 Analyzer Features**

- **Measures:**  
 O2, CO, Inlet Temperature, Flue Temperature, Hi-Res Pressure (.01~.001wg)
- **Calculates:**  
 CO2, Net Temperature, Efficiency, Excess Air, Differential Temp. (T1-T2), Differential Pressure (P1-P2), CO Air free

- Room CO Data Logger
- Heat Exchange Integrity Test
- Worklight
- 179 memory positions
- Customizable display parameters
- Programmable Headers
- Individual report printouts
- Unique rotary selector dial
- Protective boot w/integral magnet
- Real time clock
- CO readings to 1 ppm
- Large 4 line back-lit display
- Infrared printer port
- Field Replaceable Sensors<sup>1</sup>
- 3 year limited warranty (2 year warranty on sensor)



**C75KIT**  
**EAGLE 1**  
 COMBUSTION ANALYZER KIT



**Kit Includes**

Infrared Thermal Printer	KMIRP2
Flue Probe	KMCP2
AC Adapter	AACA4
Hard Carrying Case	AC509
Particle filter	
Thermal printer paper roll	
Owners guide	

**C75 Analyzer Features**

- **Measures:**  
 O2, CO, Flue Temperature
- **Calculates:**  
 CO2, Gross/Net Efficiency, Excess air, CO air free

- Protective boot w/integral magnet
- Real time clock
- CO readings to 1 ppm
- Large 2 line back-lit display
- Infrared printer port
- User programmable header
- 20 memory position
- 3 year limited warranty (2 year warranty on sensor)



**EAGLE Series**

To maintain specified accuracy UEI recommends calibration in a controlled environment against a traceable calibration gas at the UEI Service Center or by an authorized UEI representative. Field replacement services are only eligible in the United States.

**EAGLE III: C127**

NO1 (Nitric Oxide) sensors are factory replacement and calibration only and are not eligible for user or in-field service.

**C127**  
**EAGLE 3**  
 COMBUSTION & SYSTEM  
 ANALYZER

<b>Includes</b>	
Flue Probe	KMCP2
Inlet Tube/ Probe Connector	SM11103
Particle filter	17631
Hard carrying case	AC509
Battery	(4) Std "AA" 1.5V
Quick start manual	
Owners guide	

**Features**

- See page 15 for Analyzer parameters and feature details <sup>1,2</sup>



**C127OILKIT**  
 COMBUSTION OIL SERVICE KIT

**Kit Includes**  
 Same contents as the C127KIT (pg 15)  
 Includes a Smoke Pump Tester (SPT1)



**C125**  
**EAGLE 2**  
 COMBUSTION & SYSTEM  
 ANALYZER

<b>Includes</b>	
Flue Probe	KMCP2
Inlet Tube/ Probe Connector	SM11103
Particle filter	17631
Hard carrying case	AC509
Battery	(4) Std "AA" 1.5V
Quick start manual	
Owners guide	

**Features**

- See page 15 for Analyzer parameters and feature details <sup>1</sup>



**C125OILKIT**  
 COMBUSTION OIL SERVICE KIT

**Kit Includes**  
 Same contents as the C125KIT (pg 15)  
 Includes a Smoke Pump Tester (SPT1)



**C75**  
**EAGLE 1**  
 COMBUSTION ANALYZER

<b>Includes</b>	
Flue Probe	KMCP2
Inlet Tube/ Probe Connector	SM11103
Particle filter	17631
Hard carrying case	AC509
Battery	(4) Std "AA" 1.5V
Quick start manual	
Owners guide	

**Features**

- See page 15 for Analyzer parameters and feature details <sup>1</sup>



**C75OILKIT**  
 COMBUSTION OIL SERVICE KIT

**Kit Includes**  
 Same contents as the C75KIT (pg 15)  
 Includes a Smoke Pump Tester (SPT1)



**EAGLE & EAGLE X**  
 ACCESSORIES & REPLACEMENT  
 PARTS

<b>Accessories</b>	
Thermal Printer: IR Link	.....KMIRP2
Bluetooth Module	
for C155, C157, C125, C127	.....EABT
AC Adapter/Charger	.....AACA4
Smoke Pump Test Kit	.....SPT1
Hard Carrying Case	.....AC509
Soft Carrying Case	.....AC75
Draft Velocity Gauge	.....D460
Inlet Temperature Probe	.....ATT100
Eagle II/III Accessory Kit	.....EAKIT
Field Sensor Calibration Kit <sup>3</sup>	.....CALKIT <sup>3</sup>
Eagle RS232 Cable	.....EARS232

<b>ReplacementParts/Supplies</b>	
Flue Probe	.....KMCP2
Flue Probe Extension	.....FPTXT
Pressure tubing	.....11000
Thermal Paper for KMIRP2	.....16646

Thermal Paper for KMIRP2 (10 Pack)	.....16646PACK
Smoke Paper and Chart	.....SP9
Particle Filter	.....17631
Particle Filter (10 Pack)	.....17631PACK
Inlet Tube/Probe Connector	.....SM11103
Water Trap	.....SM11827
Water Trap Drain Plug	.....CM11667/2
Water Trap Drain Plug (10Pack)	.....CM11667/2PACK
K-Type thermocouple	.....ATT29
Gas Valve Pressure Adapter	
(1/4 MPT to Hose Barb)	.....BF100
O2 Sensor	.....17662*
CO Sensor	.....16184*
NO Sensor (C127)	.....17979*
Static Pressure Hose	.....SPP
Magnetic Pressure Probe Tip	.....ASP1
True Draft Probe	.....TDP
Quick Start Guide	.....17117
Manual	.....18323

\*Factory installed ONLY

**<sup>1</sup> EAGLE Series**

To maintain specified accuracy UEi recommends calibration in a controlled environment against a traceable calibration gas at the UEi Service Center or by an authorized UEi representative. Field replacement services are **only** eligible in the United States.

**<sup>2</sup> EAGLE III: C127**

NO1 (Nitric Oxide) sensors are factory replacement and calibration only and are not eligible for user or in-field service.

**<sup>3</sup> CALKIT (USA ONLY)**

The Sensor Replacement & Calibration Kit (CALKIT) is for trade professionals familiar with gas analysis and detection, with experience in calibrating gas measurement systems.



**SMART BELL  
COMBUSTION METER**



**Functions**

- Measures Carbon Dioxide, Flue Temperature
- Calculates O<sub>2</sub>, Efficiency, Excess Air, Net Temperature
- Pre-Programmed Fuels Light Oil, Propane, Natural Gas, Heavy Oil, and Wood
- 5 Year Limited Warranty (10 year expectancy)

**Includes**

Flue Probe	KMCP70
Storage Case	AC519

- Owner's Manual
- Quick Start Guide

**Replacement Parts**

Flue Probe	KMCP70
Storage Case	AC519
Protective Boot	SBOOT
Water Trap	SBWT
Water Trap plug	SBWTP
Particle Filter	17631



**C071A  
CARBON MONOXIDE DETECTOR**

**Features**

- Carbon Monoxide (ambient 0-999ppm)
- 3-color warning light
  - Green 2-9 ppm
  - Amber 10-34 ppm
  - Red w/ Audible Alert +35 ppm
- CO sensor self test
- MAX capture
- Low battery indicator
- Backlit display
- One button auto zero
- Three year product sensor warranty (Five year expected sensor life)

**Includes**

Holster w/ clip	
Battery	(1) 9V
Manual	



**C091  
CARBON MONOXIDE ANALYZER**

**Measures**

- Carbon Monoxide (Room and flue 0 ~ 1000 ppm)
- Temperature 32°~ 1112°F

- CO Max captures highest value
- Three year limited warranty
- Two year sensor warranty

**Features**

- Simple to operate DMM style selector
- Link to optional infrared printer with date and time
- Auto-zero at power up

**Includes**

Temperature probe	ATT100
Soft Carrying Case	AC75
Batteries	(4) AA
Manual	



**C091KIT  
CO ANALYZER KIT**

**Kit Includes**

C091 CO Gas Analyzer	
Infrared Thermal Printer	KMIRP2
Temperature Probe	ATT100
AC Adapter	AACA4
Thermal Paper	16646
Particle Filter	17631
Soft Carrying Case	AC75



*NOTE: For important information regarding exposure to CO levels visit [www.ueitest.com](http://www.ueitest.com)*

**KMIRP2  
INFRARED THERMAL PRINTER**

**Features**

- Compact design with a protective rubber boot w/ Integrated magnet
- Infrared port, receives readings up to 3' away without losing connection. Allowed 60° angle up to 18" away
- Communicates with UEi analyzers and analyzers using HP protocols
- Self test and battery condition function
- Detects incorrect or missing information

- Auto power down
- Paper advance
- One year limited warranty

**Includes**

Thermal Paper	16646
Batteries	4 "AAA"
Manual	



**SPT1  
SMOKE PUMP TESTER**

**Features**

- High impact barrel
- Sampling tube curved to hook securely into flue
- Solid brass shaft
- Stainless steel hardware
- Fits all types of smoke paper
- One year limited warranty

**Includes**

Smoke Test Paper	SP9
------------------	-----



**KM9106/P**  
**QUINTOX**  
 INDUSTRIAL COMBUSTION  
 SYSTEM ANALYZER

**Functions**

- Measures:
  - Oxygen (O2) 0-25%
  - Carbon Monoxide CO 0-10,000 ppm
  - Inlet Temperature 0°-999°F
  - Flue Temperature 32°-2140°F
- Calculates:
  - Efficiency 0-99.9%
  - Carbon Dioxide (CO2) 0-99.9%
  - Losses 0-99.9%
  - Excess Air 0-infinite
  - CO/CO2 0-0.999
  - Poison Index 0-99.9%
  - Net Temperature Differential
- Preprogrammed Fuels:
  - Natural Gas, Butane, Light Oil, Heavy Oil, Coal, Coke, Propane, Anthracite. LP Gas, Town Gas, Natural Gas2, Gas Core, and 2 user defined fuels.

**Features**

- Multiple line display
- Integral dot matrix printer
- Secondary printer connection (RS232)
- 1,926 test memory slots
- Rugged lockable case
- One year limited warranty

**Includes**

Filter bypass	FB1
CO sensor module	KMC01/Q
Flue probe assembly	KMCSP6
AC adapter/charger	KMCU110
O2 sensor	OS11
Replacement particle filter	16345
Sulfur Filter	SF1
Watertrap	WTS9106
Watertrap filter	WN8
Manual	

**Optional Upgrades**

Pressure (Draft) 0-60"wg1	KMPS2/Q
NO1 Sensor module <sup>1</sup>	KMNO1/Q
NO2 Sensor module <sup>1</sup>	KMNO2/Q
SO2 Sensor module <sup>1</sup>	KMSO2/Q
Hydrocarbon Sensor <sup>1</sup>	KMHC104/Q
High Range CO Sensor (measures in % to 4%)	KM6C01/Q

• **Preprogrammed Fuels:**

Natural Gas, Butane, Light Oil, Heavy Oil, Coal, Coke, Propane, Anthracite, LP Gas, Town Gas, Natural Gas2, Gas Core, and 1 user defined fuels



**QUINTOX**  
 ACCESSORIES & REPLACEMENT  
 PARTS

**Accessories/Options**

High Range CO Sensor (0 to 4%)	KM6C01/Q
High Range CO Purge Module	KM9106HPUR/Q
NO1 Sensor Module <sup>1</sup>	KMNO1/Q
NO2 Sensor Module <sup>1</sup>	KMNO2/Q
SO2 Sensor Module <sup>1</sup>	KMSO2/Q
Hydrocarbon Sensor <sup>1</sup>	KMHC104/Q
Pressure/Draft Sensor Module <sup>1</sup>	KMPS2/Q
15' Handset Extension	RE5LG
30' Handset extension lead	RE10LG
60' Handset extension lead	RE20LG
Auto Drain Water Trap <sup>2</sup>	WTS9106P
Temperature Inlet Probe	ATT100
Sulfur Filter	SF1

**Replacement Parts / Supplies**

Flue Probe Assembly	KMCSP6
Probe Shaft 12" 1000°	10051
Probe Shaft 36" 1000°	15588
Probe Shaft 36" 2000°	15590
Printer Paper and ribbon (10 rolls and 5 ribbon)	DP12
Smoke Paper and Chart	SP9
Particle Filter w/ Housing	KMAF2
Particle Filter	16345
Replacement Battery	7211
110V AC Adapter/Charger	KMCU110
AC Adapter Power Cord	PSL/US
250V AC Adapter/Charger	KMCU220
Replacement Water Trap	WTS9106
Water Trap Filter (for WTS9106)	WN8
Water Trap Filter (for metal base)	WN9
Chemical (Sulfur) Filter	SF1
Chemical Filter Bypass	FB1
Oxygen Sensor (2 Year)	OS11
Fireworks Grapher Software	KMEG1

<sup>1</sup> QUINTOX, KM940 and KM900PLUS sensors are factory replacement and calibration only and are not eligible for user or in-field service.

<sup>2</sup> Special Order ONLY

**KM940**  
INDUSTRIAL COMBUSTION ANALYZER

**Functions**

- **Measures:**
  - Oxygen (O2) 0~21%
  - Pressure (Draft)
  - Flue Temperature 0°~1112°F
- **Calculates:**
  - Efficiency 0~99.9%
  - Carbon Dioxide (CO2) 0~99.9%
  - Losses 0~99.9%
  - Excess Air 0~infinite
  - CO/CO2 0~0.999
  - Poison Index 0~99.9%
  - Net Temperature Differential
- **Customizable:**
  - Add 2 toxic gas sensors in addition to installed O2 and CO sensors
- **Preprogrammed Fuels:**  
Natural Gas, Butane, Light Oil, Heavy Oil, Coal, Coke, Propane, Anthracite, LP Gas, Town Gas, Natural Gas2, Gas Core, and 1 user defined fuel

**Features**

- High suction double-headed pump
- Multiple line display
- Infrared printer port
- 150 test memory slots
- One year limited warranty

**Optional Sensors**

Optional Sensors	Part#
CO (H2 Compensated) <sup>1</sup>	12933
CO High Range <sup>1,2</sup>	13911
NO1 <sup>1</sup>	13251
NO2 <sup>1</sup>	10533
SO2 <sup>1</sup>	13910

**Includes**

Pressure sensor	KMPS4
Replacement particle filter	16345
AC adapter/Charger	KMCU900/110
Watertrap assembly	WT900/2
Large cordura case	
Manual	



**KM900PLUS**  
INDUSTRIAL COMBUSTION ANALYZER

**Functions**

- **Measures:**
  - Oxygen (O2) 0~21%
  - Carbon Monoxide CO 0~10,000 ppm (H2 Compensated)
  - Pressure (Draft)
  - Flue Temperature 0°~1112°F
- **Calculates:**
  - Efficiency 0~99.9%
  - Carbon Dioxide (CO2) 0~99.9%
  - Losses 0~99.9%
  - Excess Air 0~infinite
  - CO/CO2 0~0.999
  - Poison Index 0~99.9%
  - Net Temperature Differential
- **Customizable:**
  - Add 2 toxic gas sensors in addition to installed O2 and CO sensors
- **Preprogrammed Fuels:**  
Natural Gas, Butane, Light Oil, Heavy Oil, Coal, Coke, Propane, Anthracite, LP Gas, Town Gas, Natural Gas2, Gas Core, and 1 user defined fuels

**Features**

- Multiple line display
- Infrared printer port
- 150 test memory slots
- One year limited warranty

**Optional Sensors**

Optional Sensors	Part#
NO1 <sup>1</sup>	13251
NO2 <sup>1</sup>	10533
SO2 <sup>1</sup>	13910

**Includes**

Pressure sensor	KMPS4
Replacement particle filter	16345
AC adapter/Charger	KMCU900/110
Watertrap assembly	WT900
Large cordura case	
Manual	



**KM9 SERIES**  
ACCESSORIES & REPLACEMENT PARTS

**Accessories/Options**

Thermal Printer - IR Link	KMIRP2
CO Sensor 0~10,000 ppm	
H2 Compensated <sup>1</sup>	12933
CO Sensor (KM940 Only)	
HiRange 0~10% <sup>2</sup>	13911
NO Sensor 0 ~ 5,000 ppm <sup>1</sup>	13251
NO Sensor Lo Range	
0 ~ 100 ppm <sup>1</sup>	18079
NO2 Sensor	
0 ~ 1,000 ppm <sup>1</sup>	10533
SO2 Sensor 0 ~ 5,000 ppm <sup>1,2</sup>	13910
SO2 Sensor Lo Range	
0 ~ 100 ppm) <sup>1</sup>	18131
Pressure Sensor (Differential)	KMPS4

**Replacement Parts/Supplies**

Flue Probe	KMCP10
Thermal Paper for KMIRP2	16646
Smoke Pump	SPT1
Smoke Paper and Chart	SP9
Particle Filter	16345
Battery	16486
AC Adapter/Charger	KMCU900/110
AC Adapter Power Cord	PSL/US
Water Trap (Case Mount)	WT900/2
O2 Sensor: 2 yr warranty	OS12
Pressure Sensor (Differential) <sup>1</sup>	KMPS4
Fireworks Reporter	
Software	KMFR1

<sup>1</sup> QUINTOX, KM940 and KM900PLUS sensors are factory replacement and calibration only and are not eligible for user or in-field service.

<sup>2</sup> Special Order ONLY

**LPKIT**  
LP PRO KIT

- Kit Includes**
- CD100A Combustible Gas Leak Detector
  - EM151 Electronic Manometer
  - Hard Carrying Case AC504



**LPKITPLUS**  
LP PRO+ KIT

- Kit Includes**
- CD100A Combustible Gas Leak Detector
  - CO71A Carbon Monoxide Detector
  - EM151 Electronic Manometer
  - Hard Carrying Case AC504



**DSM101**  
DIGITAL SOUND METER

- Features**
- Measures 4 ranges 40 to 130 dB (0.1dB resolution)
  - Automatic or manual ranging
  - Maximum level hold
  - Over and under indication
  - Fast and slow dynamic response
  - A and C weighting
  - Three year limited warranty

- Includes**
- |         |               |
|---------|---------------|
| Battery | (4) Std "AAA" |
| Manual  |               |



**MW1AK**  
MICROWAVE LEAK DETECTOR

- Features**
- Color-coded scale indicates microwave leakage
  - Attached wand is easy to hold and allows detection in small spaces
  - 0-2mV/cm<sup>2</sup> Range
  - Frequency response of 2450 MHz
  - One year limited warranty

- Includes**
- Manual
- NOTE: Not Certifiable*



**DLM2**  
DIGITAL LIGHT METER

- Features**
- 0 – 5000 foot-candles
  - Over 3 lux ranges
  - Accurate to ±5% w/ 0.4 sec sampling rate
  - Easy to read LCD display
  - One year limited warranty

- Includes**
- |         |            |
|---------|------------|
| Battery | (1) Std 9V |
| Manual  |            |



**MM100**  
DIGITAL MOISTURE METER

- Features**
- Range
    - Wood: 6-44%
    - Material: 0.2-2.0%
  - Accuracy
    - Wood: ±1%
    - Material: ±0.05%
  - Relative humidity 0-85%
  - Replaceable electrode pins
  - Built-in belt clip
  - Auto power off

- Battery check test
  - One year limited warranty
- Includes**
- |           |            |
|-----------|------------|
| Batteries | (3) CR2032 |
| Manual    |            |



**CLM100**  
CABLE LENGTH METER

- Features**
- Measures copper and aluminum cables; covers the major wire gauges
  - Automatic temperature compensation
  - Reads in feet and meters
  - Milliohm measurement capability
  - Measures 15 to 30,000'
  - Wire size: 26 ga - 4/0
  - 250 MCM - 500 MCM
  - Resistance 65Ω
  - Auto off
  - Two easy-to-attach Kelvin Clip leads connect to cable

- Five year limited warranty
- Includes**
- |                 |            |
|-----------------|------------|
| Test Leads      | ATL190     |
| Calibration bar | 15154      |
| Hard Case       | AC504      |
| Battery         | (1) Std 9V |
| Manual          |            |



**RLD15**  
REFRIGERANT LEAK DETECTOR

**Features**

- Detects Industry Standard Refrigerants:  
HFC: R-134a, R-410A, R-404A, R-407C & R-507  
(R-134a, R410A sensitivity  $\geq 0.05$  oz/yr)  
HCFC: R-22 (R-22 sensitivity  $\geq 0.025$  oz/yr)  
CFC: R-12  
Hydrocarbon Blends: HC-12a®, OZ-12a®
- Long Life Heated Sensor Technology
- Digital Numeric Leak Size Indicator
- 3 Sensitivity Levels
- Visual LED Leak Alarm
- Automatic Calibration & Ambient Level Reset
- Splash Resistant
- 3 Year Limited Warranty (Includes Sensor)

**Includes**

- Batteries (4) AA
  - 1 (5 pack) Sensor Filters
  - Leak Test Vial
  - Manual
  - Hard Carrying Case
- Replacement Parts**
- Sensor RLD15SENS
  - Sensor Filter (5 pack) RLDTF
  - Leak Test Vial RLDLS



**RLD10**  
REFRIGERANT LEAK DETECTOR

**Features**

- Sensitive to .5 oz per year R134A.
- Detects all existing halogenated refrigerants and blends (R123, R410A, R22).
- Two position sensitivity selector
- Audible tick and visual indicators identify refrigerant leak rate
- Auto zeros when turned on
- 18 1/2" long gooseneck probe
- One year limited warranty

**Includes**

- Battery (1) Std 9V
  - Manual
- Replacement Parts**
- Sensor Cap RLDTG
  - Sensor RLDSENS



**CD200**  
COMBUSTIBLE GAS LEAK DETECTOR

**Features**

- 50 ppm minimum detection
- Long 18" gooseneck
- Detects: Acetone, Alcohol, Ammonia, Benzene, Ethelene Oxide, Gasoline/Petrol, Halon, Hydrogen Sulfide.
- Visual LED Leak Detection Indicator
- User adjustable alarms level detection
- Precision sensor detects even the smallest leaks
- Work Light in sensor cap
- Adjustable tick rate
- Fast response time of less than two seconds to 40% LEL

- Headphone jack
  - Three year limited warranty
- Includes**
- Battery (4)Std "AA"
  - Hard Carrying Case
  - Manual

- Replacement Parts**
- Sensor Cap RS1010
  - Sensor RS1000



**CD100A**  
COMBUSTIBLE GAS LEAK DETECTOR

**Features**

- 50 ppm minimum detection
- Long 18" gooseneck
- Detects: Acetone, Alcohol, Ammonia, Benzene, Ethelene Oxide, Gasoline/Petrol, Halon, Hydrogen Sulfide.
- Work Light in sensor cap illuminates the search area
- Precision sensor detects even the smallest leaks
- Adjustable tick rate
- Headphone jack
- One year limited warranty

- Includes**
- Battery (1) Std 9V
  - Manual

- Replacement Parts**
- Sensor Cap RS1010
  - Sensor RS1000



**EM201**  
DUAL INPUT  
ELECTRONIC MANOMETER

**Features**

- Dual input differential measurement to  $\pm 40$ " wg or 100 mBar
- MIN/MAX value capture
- Data hold
- Backlit display
- Ruggedized, including rubber boot with integral magnet
- Auto power-off
- One year limited warranty

**Includes**

- 2 Pressure tubes w/ brass fitting connector BF100
- Battery (1) Std 9V
- Manual



**EM151**  
ELECTRONIC MANOMETER

**Features**

- Single input measurement to  $\pm 20$ " wg or 50 mBar
- Ruggedized, including rubber boot with integral magnet
- Simple two-button operation
- Measures in inches water gauge & Mbar
- Auto power-off after 5 minutes of no activity
- One year limited warranty

**Includes**

- 1 Pressure tube w/ brass fitting connector BF100
- Battery (1) Std 9V
- Manual



## DMEG3 DIGITAL INSULATION RESISTANCE TESTER

### Features

- Large digital display shows test function & measured value
- AC Voltage Measurement to 600 Volts
- Insulation resistance ranges 0 – 2000M $\Omega$
- Three test-voltage ranges (250, 500, 1000V DC)
- Live circuit warning light
- Fuse protected
- Precision resistance 0.01 $\Omega$
- 200 mA short-circuit continuity test current for high accuracy
- Precision, low resistance test leads (1000 Volt CAT III rated)
- Audible continuity

- Green LED power-on indicator
- Low battery indication/detection
- Maintains rated voltage on cables with up to 1 mA leak-rate
- Automatic, post-test cable discharge
- Three year limited warranty

### Includes

Test Leads	ATL55
Battery	(8) Std "AA"
Fuse	AF21
Manual	



E112971  
MET<sup>®</sup>  
C US  
ELECTRICAL SAFETY

## IRT3 ANALOG INSULATION RESISTANCE TESTER

### Features

- Large high-contrast analog display
- AC Voltage Measurement to 600 Volts
- Insulation resistance readings from 0 to 400 Megohms
- Three test-voltage ranges (250, 500, 1000 V DC)
- Live circuit (external voltage applied) warning light
- Fuse protected against accidental misuse
- Precision, low resistance test leads (1000 Volt CAT III rated)
- Low battery indication/detection

- Maintains rated voltage on cables with up to 1 mA leak-rate
- Automatic, post-test cable discharge
- Three year limited warranty

### Includes

Test Leads	ATL55
Battery	(8) Std "AA"
Fuse	AF21
Manual	



E112971  
MET<sup>®</sup>  
C US  
ELECTRICAL SAFETY

## IRT20 HAND-CRANKED INSULATION RESISTANCE TESTER

### Features

- 250, 500 and 1000 Volt output ranges
- Sealed, water resistant rugged metal housing
- Damping time exceeds 4 seconds
- Hand-crank power supply
- Accurate to within one division
- One year limited warranty

### Includes

Test Leads	ATL91
Manual	



## HA1 HERMETIC COMPRESSOR ANALYZER

### Features

- 3 ranges of 250 VAC starting capacitors between 88-301 MFD
- Dual voltage operation of 120/240 VAC
- Indicates continuity and ground faults in motor windings with LED lights
- Free locked rotors by reversing motor action
- Convenient breakout jacks for measuring voltage and resistance
- Three year limited warranty

### Includes

Adapter Cord	ACF1
Manual	



## PSMR1 PHASE SEQUENCE AND MOTOR ROTATION TESTER

### Features

- Three functions in one unit:
- Open phase indication
- Phase rotation sequence
- Motor rotation indication (fused)
- Identifies 3-phase sequence
- Checks for open phases
- Input voltage: 100V - 600V AC
- Frequency range: 45 – 70Hz
- Battery operated
- Three year limited warranty

### Includes

Test Leads	
Soft Carrying Case	
Manual	



UL<sup>®</sup>  
LISTED



**ECT690**  
ELECTRICAL TESTER

- Features**
- AC Volts 12 to 690
  - DC Volts 6 to 220
  - Continuity
  - One year limited warranty

**Includes**  
Battery: \_\_\_\_\_ (2) AA  
Manual



**PET1**  
POCKET ELECTRICAL TESTER

- Features**
- Worklight
  - Non-contact AC voltage test: from 12 – 600V AC (with adjustable sensitivity)
  - Detects high and low AC Voltage
  - Continuity check: 0 – 80 MΩ
  - Three year limited warranty

**Includes**  
Battery: \_\_\_\_\_ (2) AB13  
Manual



**NCV2**  
POCKET ELECTRICAL TESTER

- Features**
- Non-contact AC voltage test: from 50 – 1000V AC
  - 50 - 60Hz
  - Bright LED Indicator
  - Audible Alert
  - Built in Battery Tester

**Includes**  
Battery: \_\_\_\_\_ (2) "AAA"  
Manual



**ECTGFI**  
GROUND FAULT INDICATOR

- Features**
- 110V AC outlets
  - One year limited warranty

**Includes**  
Manual



**ECT120**  
ELECTRICAL TESTER

- Features**
- 110V AC outlets
  - One year limited warranty

**Includes**  
Manual



**ECT1K**  
CONTINUITY TESTER

- Features**
- Continuity
  - Indicator light
  - One year limited warranty.

**Includes**  
Battery: \_\_\_\_\_ (2) AA  
Manual



**ECT460K**  
VOLTAGE TESTER

- Features**
- Scaled AC V indicators
  - 110 - 480V
  - One year limited warranty

**Includes**  
Manual



**MA1**  
AC AMMETER

- Features**
- Ranges: 0-1.2 AC Amps
  - Accuracy: ±3% of full scale
  - One year limited warranty

**Includes**  
Manual



## MOTORS

All Motors are 50/60Hz, 1550RPM at 60Hz, have fully enclosed metal housings, external oil ports and are UL and CSA listed.

### CAST IRON HOUSING

Part Number	Watts	Voltage	UL	Industry Reference	Rotation	UPC
UEM1021	2W	115VAC	Yes	5109	CW	05353380050
UEM1025	2.5W	115VAC	Yes	5111	CW	05353380051
UEM1041	4W	115VAC	Yes	5211	CW	05353380052
UEM1042	4W	115VAC	Yes	5212	CCW	05353380053
UEM1061	6W	115VAC	Yes	5311	CW	05353380054
UEM1062	6W	115VAC	Yes	5312	CCW	05353380055
UEM1091	9W	115VAC	Yes	5411	CW	05353380056
UEM1092	9W	115VAC	Yes	5412	CCW	05353380057
UEM1161	16W	115VAC	Yes	5811	CW	05353380058
UEM1162	16W	115VAC	Yes	5812	CCW	05353380059
UEM2091	9W	230VAC	Yes	5421	CW	05353380062
UEM2092	9W	230VAC	Yes	5422	CCW	05353380063
UEM2161	16W	230VAC	Yes	5821	CW	05353380064
UEM2162	16W	230VAC	Yes	5821	CCW	05353380065

Each motor furnished with hub washer, speed nut, neoprene silencer/vibration damper, and 3 mounting screws.

### ALUMINUM HOUSING

Part Number	Watts	Voltage	UL	Industry Reference	Rotation	UPC
UEM1021AL	2W	115VAC	Yes	5109	CW	05353380066
UEM1041AL	4W	115VAC	Yes	5213	CW	05353380067
UEM1042AL	4W	115VAC	Yes	5214	CCW	05353380068
UEM1061AL	6W	115VAC	Yes	5313	CW	05353380069
UEM1091AL	9W	115VAC	Yes	5413	CW	05353380071
UEM1092AL	9W	115VAC	Yes	5414	CCW	05353380072

All motors sold in 12 lot quantities.

Cast Iron



Aluminum



## TRANSFORMERS

### CONTROL TRANSFORMERS

Part Number	Primary Voltage	Secondary Voltage	Output Volt/Amps	Breaker or Fuse	Type Mount	Multi Tap	Connection Type (Primary)	Connection Type (Secondary)	UPC
UET100R**	120, 208, 240, 480	24	100VA	CB	Foot	Yes	Wires	Wires*	05353380035
UET101	120, 208, 240	2.5, 12, 24	40VA	Fuse	Foot	Yes	Wires	Wires*	05353380001
UET105	120, 208, 240	24	40VA	No	Foot	Yes	Wires	Wires*	05353380002
UET111	120, 208, 240	2.5, 12, 24	40VA	Fuse	Multi	Yes	Quick Clamp	Wire Nuts*	05353380004
UET112	120	24	40VA	No	Multi	Yes	Quick Clamp	Screw	05353380005
UET113	208, 240	24	40VA	No	Multi	Yes	Quick Clamp	Screw	05353380006
UET114	120, 208, 240	24	20VA	No	Foot	Yes	Wire Nuts	Wires*	05353380007
UET115	120, 208, 240	24	40VA	No	Foot	Yes	Wire Nuts	Wires*	05353380008
UET150	120, 208, 240	24	50VA	Fuse	Multi	Yes	Wire Nuts	Screw	05353380009
UET160	208, 240	24	60VA	Fuse	Foot	Yes	Wire Nuts	Wire Nuts*	05353380013
UET175	120, 208, 240	24	75VA	Fuse	Foot	Yes	Wire Nuts	Wire Nuts*	05353380020
UET79R	120, 208, 240, 480	24	75VA	CB	Foot	Yes	Wire Nuts	Wire Nuts*	05353380034

\* Wires are color coded for easy installation



UET113 W/ Quick Clamp Connection

### RINGER TRANSFORMERS

The Ringer Transformer series covers a broad range of bell and chime applications. All models feature Quick Clamp primary hook-ups, screw terminal secondary hook-ups and mount with foot or knock-out clamp.

Part Number	Primary Voltage	Secondary Voltage/VA	Type Mount	Multi Tap	UPC
UET10	120	6/5, 10/5, 16/10	1 <sup>1</sup> / <sub>16</sub> " x 2"	Yes	05353380000
UET10A	120	16/10	1 <sup>1</sup> / <sub>16</sub> " x 2"	No	05353380003
UET20	120	8/10, 16/10, 24/20	1 <sup>1</sup> / <sub>4</sub> " x 2"	Yes	05353380027
UET30	120	8/20, 16/20, 24/30	1 <sup>3</sup> / <sub>4</sub> " x 2"	Yes	05353380028
UET32	120, 240	8/20, 16/20, 24/30	1 <sup>3</sup> / <sub>4</sub> " x 2"	Yes	05353380116
UET34	120	16/30	1 <sup>3</sup> / <sub>4</sub> " x 2"	No	05353380081

\*\* All Transformers are UL and CUL listed except the UET100R  
All transformers are sold in case quantities.



UET30 W/ Secondary Screw Terminals



**UTL33T**  
DIGITAL MULTIMETER



- Functions**
- AC Voltage 200V/600V
  - DC Voltage 200mV/2V/20V/200V/600V
  - DC current 200µA/2mA/20mA/200mA/10A
  - Resistance 200Ω/2kΩ/20kΩ/200kΩ/200MΩ
  - Audible continuity
  - Temperature
  - Data hold
  - Impact resistant boot with a tilt stand
  - One year limited warranty

- Includes**
- Test Leads ATL55
  - Batteries (1) 9V
  - Temp. Probe Adapter ATT70
  - Manual



**UTL2K**  
COMPACT  
ANALOG MULTIMETER

- Functions**
- Easy to read, color coded scale plate and front panel
  - Diode protected meter movement
  - Pocket size
  - One year limited warranty

- Includes**
- Test Leads ATL55
  - Batteries (1) AA
  - Manual



**UTL260**  
DIGITAL  
CLAMP-ON METER

- Functions**
- AC current 2A/20A/200A
  - AC/DC voltage 600V
  - Resistance 2kΩ
  - Audible continuity
  - LCD display with MAX reading 1999
  - Automatic indication of functions and symbols
  - Sample rate: 2 times/sec for digital data

- Backlit display for use in low light application
  - One year limited warranty
- Includes**
- Test Leads ATL55
  - Batteries 04240
  - Manual



**UTL7002**  
POWER DETECTOR

- Functions**
- Detect live voltages (50 to 500 ACV and 30 to 220 DCV)
  - AC and DC voltage detection
  - One year limited warranty

- Includes**
- Batteries AB13



**UTL2002**  
WATER LEAKAGE  
INDICATOR

- Functions**
- 9 Volt battery operated
  - Jack for conventional 9 Volt adapter
  - Remote sensor with 7" cord
  - Longer remote-sensor cord is easily added
  - Suction-cup mounted sensor
  - Visual (LED) and loud audible alarms
  - Self test button

- Mounting hardware included
  - One year limited warranty
- Includes**
- Batteries (1) 9V
  - Manual



**Fuses**

PART #	USED WITH	RATING	UPC
AF2	M20	(.15A, 2 Ohms)	05353360056
AF3	MCP4	(.5A, .5 Ohms)	05353360059
AF5	M75A/M80A	(.25A, 2 Ohms)	05353360064
AF10	M110A	(.6A, .5 Ohms)	05353360052
AF21	IRT3, DMEG3	(1A< .2 Ohms)	05353360213
AF38	DM391/DM393	(440mA, 1000V Fuse)	05353360517
AF39	DM391/DM393	(11A, 1000V Fuse)	05353360518
AF45	MCP4, MCP9A	(0.3A, 1.3 Ohms)	05353360063
AF112	DL293, DL295, DL297, DL297T	(2A, 600V)	05353360219
AF113	DL293, DL295, DL297, DL297T	(15A, 600V)	05353360220
AF145	DM400, DL250	(.5A, 250V 5 x 20mm)	05353360295
AF155	DM383B, DM384	Capacitance Range	05353360378
AF160	DM383B, DM384, DI250, DI259	(12.5A, 250V 6 x 32mm)	05353360379
AF250	DM5B	(0.5A, 250V Fuse)	05353360392
AF251	DM5B	(0.5A, 250V Fuse)	05353360393



## Clips & Adapters

<b>ATTPC</b>	Pipe Clamp Adapter for use with K-type inputs
<b>ATTPC2</b>	Clamp Style Adapter for use with K-type inputs
<b>AWL1</b>	FIREFLY Wristlight™ LED light attaches to wrist, fingers, or test leads
<b>AAC</b>	Push-on alligator clips with insulators for pointed test leads, 1 pair
<b>AAC3</b>	Screw-on alligator clips, 1 pair
<b>ACF1</b>	110V AC female adapter connector to insulated battery clips, for HA1
<b>ATHA1</b>	Gas valve thermocouple adapter
<b>ALS1</b>	Line Splitter
<b>CPA1</b>	Capacitance adapter for DMMs
<b>DLMAT2</b>	MicroAmp adapter for DMMs
<b>TA2K</b>	Dual input differential temperature adapter for DMMs
<b>ACS1</b>	Velcro pipe straps for thermocouple probes
<b>ATTEXT</b>	10' Extension for K-type thermocouples
<b>CA30</b>	Clamp On Adapter for DMM
<b>CA383B</b>	Clamp On Adapter for DMM



## Test Leads

<b>ATL55</b>	UL listed insulated test leads for industry standard multimeters
<b>ATL59</b>	UL listed insulated test leads for Phoenix Clamp Meter Series™
<b>ATL60</b>	Test lead, microwave diode booster for all DMM (except DM5B)
<b>ATL85</b>	Vinyl insulated test leads for M1K
<b>ATL91</b>	Test lead set for IRT20
<b>ATL130</b>	Rubber insulated test leads, twist lock (pr.) for MCP9A
<b>ATL135</b>	Test leads for IRT3 & DMEG3
<b>ATL190</b>	Kelvin clip leads for CLM100 & CLM100B
<b>ATL250</b>	Test leads for DM5B
<b>ATL301KIT</b>	Deluxe test lead kit
<b>ATLFSG</b>	Flame safeguard relay kit, w/test lead and alligator clips

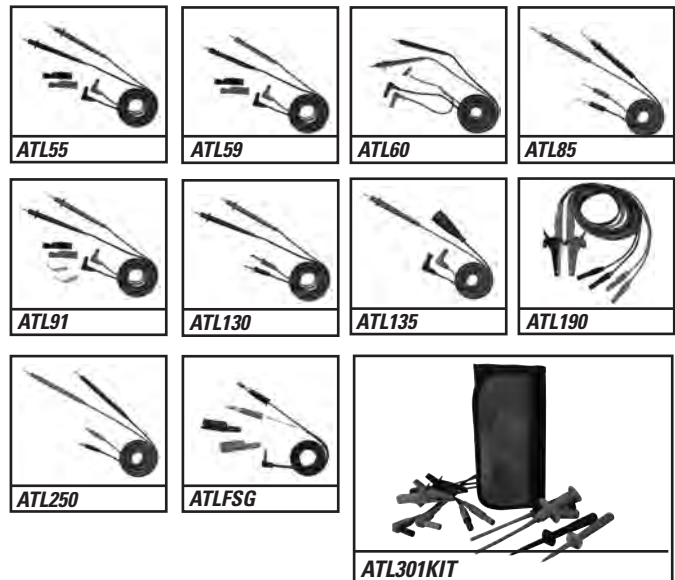

## Batteries

AB13

**Functions**

- For DM5B, PDT550, 550B, PET1, DTH880.



AB14

**Functions**

- For PDT500, 300AC.



## J-Type Temperature Probe

- ATT19** Oven clip, flat blade 48" cord. DT301, DT302, DT304 (-40°-950°F / -40°-510°C)
- ATT26** Liquid probe and 48" cord. DT301, DT302, DT304 (-40°-1,550°F / -40°-850°C)
- ATT27** 4' Standard bead probe. DT301, DT302, DT304 (-40°-950°F / -40°-510°C)
- ATT30** 8" Liquid probe & handle. DT301, DT302, DT304 (-40°-1,550°F / -40°-850°C)

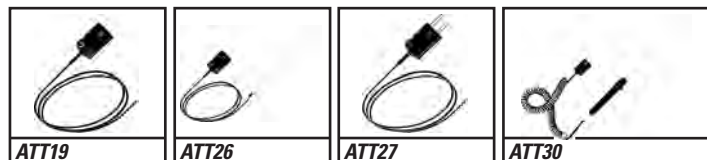

## K-Type Temperature Probe

- ATT29** 4' Standard fiber glass coated. DT301, DT302, DT304, DL389, DL379, DL369, DL259, DL250, & TA2K (-40° to 950°F / -40° to 510°C)
- ATT29A** 4' Standard Teflon coated FDA approved. DT301, DT302, DT304, DL389, DL379, DL369, DL259, DL250, & TA2K (-40° to 950°F / -40° to 510°C)
- ATT29APACK** 10 PACK 4' Standard Teflon coated FDA approved.
- ATT36** 8" Surface probe and handle. DT301, DT302, DT304, DL389, DL379, DL369, DL259, DL250, DT200, & TA2K (-40° to 950°F / -40° to 510°C)
- ATT39** Temperature probe for the DT301, DT302, DT304 (-40° to 950°F / -40° to 510°C)
- ATT50** 8" Liquid probe & handle. DT301, DT302, DT304, DM520, DL297T, DL295, DL250, & TA2K (-40° to 1,550°F / -40° to 850°C)
- ATT70** Temperature plug adapter. DL259, DL289, DL279, DL269, DM397, DM393, UTL33T
- ATT100** 6" Liquid probe and handle. DT301, DT302, DT304, DL389, DL379, DL369, DL259, DL250, & TA2K (-40° to 950°F / -40° to 510°C)

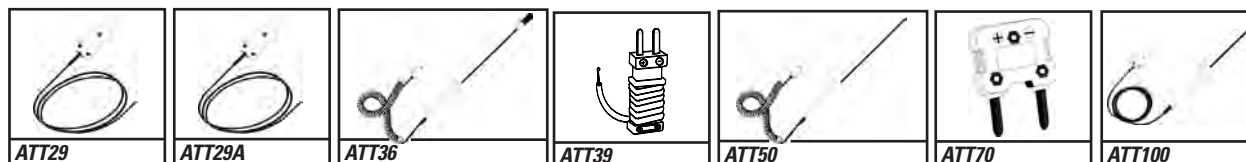

## Thermistor

- ATT31** External temperature probe. DTH31 (-4° to 158°F / -20° to 70°C)
- ATT55A** 4" Liquid temperature probe with 30" cord. DT20A, DT15A
- ATT56A** 4" Air temperature probe with 30" cord. DT20A, DT15A
- ATT57A** 4" Surface temperature probe with 30" cord. DT20A, DT15A
- ATT58A** Sealed probe with 15' cord. DT20A, DT15A
- ATT62** Sealed probe with 15' cord. DT40 (-40° to 300°F / -40° to 150°C)
- ATT64** Air probe with 15' cord. DT40 (-40° to 300°F / -40° to 150°C)

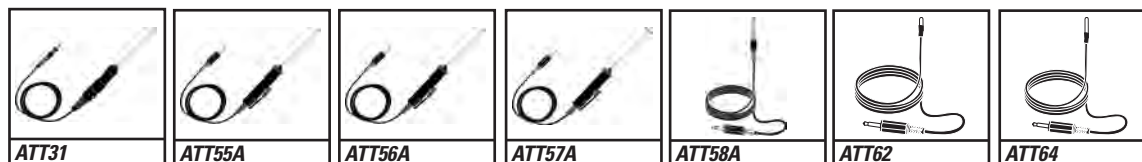

## Carrying Cases

- AC73** Soft carrying case (15 x 12 x 3")
- AC75** Large soft carrying case (18 x 12 x 3")
- AC504** Hard carrying case (12.5 x 7.5 x 3.5")
- AC506** Large hard carrying case (16 x 11 x 3.75")
- AC509** Eagle hard carrying case (19 x 14 x 3.5")
- AC319** Soft carrying case (5.5 x 7.5 x 2.5")
- AC519** Soft carrying case (5.5 x 10.5 x 2.5")



## PRODUCT SERVICE AND SUPPORT

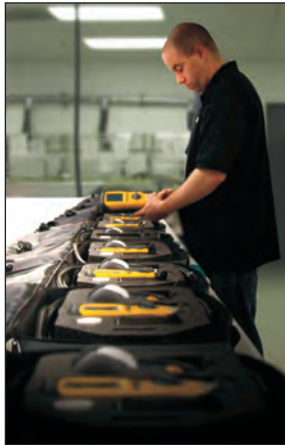

When you purchase a UEi product you get more than high quality and innovative products, you also get a team committed to ensure your level of satisfaction is fulfilled and unmatched.

It starts with quality control inspections to ensure proper instrument operations prior to shipping, and is supported by industry-leading warranties without the small print. Our knowledgeable and helpful customer service team is empowered to get problems solved quickly. Whether in the field or online, our technical support is accessible via phone or e-mail to provide intelligent solutions as needed. And finally, our on-staff service and repair technicians offer reliable and prompt turn around or take advantage of our in-field sensor calibration and replacement service.

We understand the importance of a contractor's tools, and how their choice affects their relationship with the customers. Our goal is to reaffirm the confidence of choice after the purchase.

The UEi brand stands for innovation, quality, and great service. When you compare UEi to other brands, you won't find a better value for your dollar, and you won't find another company more committed to your satisfaction.



For Service, Warranty returns or repairs,

**USA**  
**CALL 1-800-547-5740**  
 Send the unit postage paid to:  
**UEi**  
**8030 SW Nimbus Ave.**  
**Beaverton, OR 97008**

**CANADA**  
**CALL 1-877-475-0648**  
 Send the unit postage paid to:  
**UEi CANADA**  
**150-13571 Verdun Place**  
**Richmond, B.C.**  
**V6V 1W6**

## MERCHANDISE AND BRANCH SUPPORT

### DISPLAY1

#### WALL MOUNT DISPLAY



#### Features

2' x 4' metal grid display includes header sign, reorder tags, mounting hardware, grid hooks and instructions.

The Wall Mount Display is an ideal option for places where traditional peg-board or slatwall displays don't exist or where floor space is limited.

This dynamic presentation will put premium wall space to work and is sure to draw interest and stand out from typical wall presentations.

### PBC

#### PEG BOARD DISPLAY COVER



#### Features

2 x 4' Red flexible PVC roll with 5/16" stripped holes aligned 1" on center. Includes plastic fasteners, reorder tags and header sign.

The Peg Board Cover is perfect way to dress up traditional peg boards or gondola displays. The bright red color draws attention and helps keep inventory looking organized. The durable material is tough enough not to tear but can easily be cut to customize to space requirements.

### DISPLAY2

#### FREE STANDING DISPLAY



#### Features

2' x 6' metal grid display includes header sign, reorder tags, hardware, grid hooks, and instructions.

The UEi Free Standing Display is great for the end of aisles, as a counter extension, or anywhere open floor space is available.

Being the largest rack, it allows a wide range of products to be displayed. Sturdy and visually appealing the Free Standing display is a sharp addition to any store.

### SDC

#### SLATWALL DISPLAY COVER



#### Features

16 red 2.5 x 24" adhesive strips with UEi logo. Includes header sign, reorder tags and application instructions.

The Slatwall Display Cover is a unique and stylish way to merchandise your UEi stock. Apply directly to slatwalls and reapply without the worry of leaving residue on surface. Strips can easily be cut to customize to space requirements.

Slatwall covers can also be ordered individually without support material.

### HEADER HEADER SIGNS

#### Features

2' x 7" color sign with 2 hanging holes making it easily identifiable and helping direct customers to the testing equipment displays.



**USA**  
 1-800-547-5740 • Fax: (503) 643-6322  
 www.ueitest.com • Email: info@ueitest.com

8030 SW Nimbus Ave.  
 Beaverton, OR 97008

**CANADA**  
 1-877-475-0648 • Fax: (604) 278-8299  
 www.ueitest.com • Email: info@ueitest.com

150-13571 Verdun Place  
 Richmond, B.C.  
 V6V 1W6

**EUROPE**  
 +44 1707 375550 • Fax: +44 1707 393277